

## 183 系列充油式压力表

## 183 Liquid Filled Pressure Gauges

## Description

183 系列与 181 系列相同，但采用卡口式表圈，便于维修。用于各种极端环境或高纯度设备。

183 series are all SS gauges as 181 series but with bayonet bezel, it means this gauge is repairable. This series also can be used under critical environment or high pure devices.



183A

## Material Feature

指针 Pointer:	铝 Aluminium	焊接类型 Welding Type:	氩弧焊 Argon-arc Welding
机芯 Movement:	不锈钢 SS304	外壳 Case:	不锈钢 SS304
接头 Connection:	不锈钢 SS316	表圈 Ring:	不锈钢 SS304
精度 Accuracy:	1.6%/1.0%*	螺纹尺寸 Thread Size:	1/8", 1/4", M14
表面 Window:	聚碳酸酯 Polycarbonate	弹簧管 Bourdon Tube:	不锈钢 SS316L
填充液 Filling Liquid:	甘油 Glycerine	压力范围 Pres. Range:	VAC~9PSI~15000PSI
*1.0%的精度可定制 *1.0% accuracy is available when required			

**Dimensions**

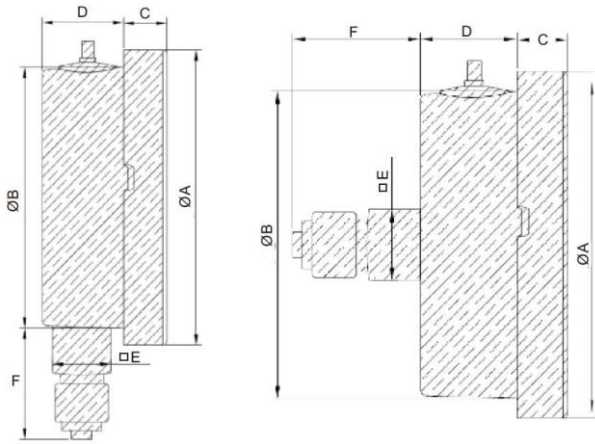

Code	Dia (mm)	Sizes (mm)					
		A	B	C	D	E	F
B183	50	58.0	50.5	10.4	18.6	14.0	26.0
C183	63	69.0	61.0	10.4	18.6	14.0	26.0

**Main Mount type**



**Bottom Mount**



**Back Mount**



**Solder interface**

