

PT0 MEMS Type - Industrial Pressure Transmitter

Sensor type	MEMS
Default connector	1/4"NPT(Customizable)
Thread size	M12x1.25(Customizable)
Protection	IP65
Pressure response time	< 5ms
Burst pressure	2X Absolute pressure
Working temp	-20~120°C
Accuracy	0.5% F.S



M12 connector



Big Hirschmann connector



Small Hirschmann connector



Direct line connector

- ▲ Long durability
- ▲ High stability
- ▲ Wide range of media
- ▲ Low temperature drift
- ▲ High burst pressure ratio

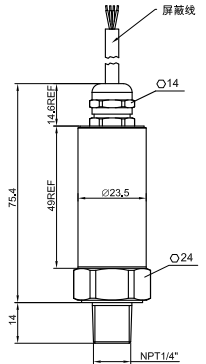
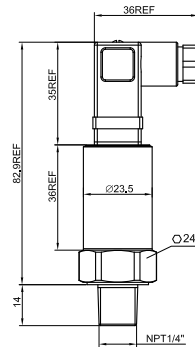
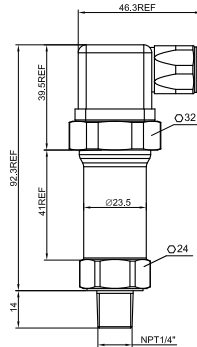
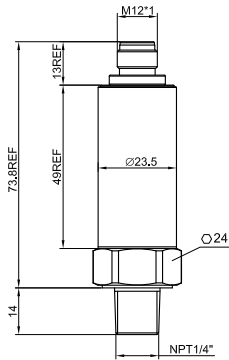

*All dimensions in MM.

Code Identify

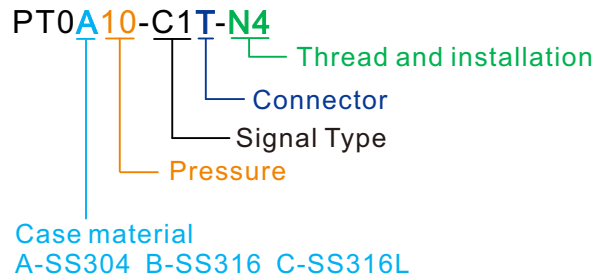

Thread and installation	
N4	1/4"NPT
B4	1/4"BSP
S7	7/16-20UNF
T4	1/4"BSPT
M145	M14x1.5
M125	M12x1.5

Pressure Range					
1.0	0-1.0bar	6.0	0-6.0bar	11.0	0-11.0bar
2.0	0-2.0bar	7.0	0-7.0bar	12.0	0-12.0bar
3.0	0-3.0bar	8.0	0-8.0bar	13.0	0-13.0bar
4.0	0-4.0bar	9.0	0-9.0bar	14.0	0-14.0bar
5.0	0-5.0bar	10.0	0-10.0bar	15.0	0-15.0bar

Signal Typ(Customizable)		
Signal	Input	Output
C1	12-30V	4-20mA
T1	12-30V	0-5V
T2	12-30V	0-10V
F4	5V	0.5-4.5V

Connector	
M	M12
T	Big Hirschmann connector
S	Small Hirschmann connector
D	Direct line connector